

Plastkeðjur

Plastkeðja bein

Tegund	K	TT	H
LF 820 K 325	82.5	4	9,5
LF 820 K 400	101.6	4	9,5
LF 820 K 450	114.3	4	9,5
LF 820 K 600	152.4	4	9,5
LF 820 K 750	190.5	4	9,5

Allar tölur í mm

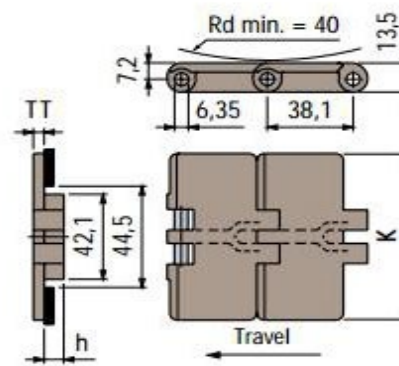

Plastkeðja bein

Tegund

LF 821 K 750

LF821 K 1000

LF821 K 1200

Allar tölur í mm

K

190.5

254.0

304.8

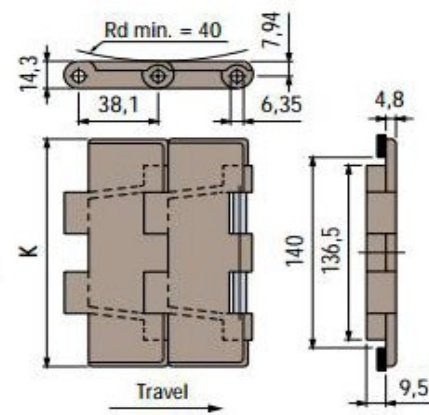

Tannhjól fyrir plastkeðju LF 820 og 821

KUS 820

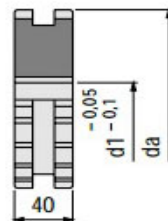

Split Thermoplastic (KUS) Sprockets

Rexnord Order No.	No of Teeth		Pitch Dia. d mm	Outside Dia. da mm	Finished Bore with Keyway d1 mm	Weight kg
	Actual	Effective				
KUS 820 T19 R...*	19	9,5	117,35	117	20 • 30 35 40	0,40
KUS 820 T21 R...*	21	10,5	129,26	129,5	20 • 30 35 40	0,50
KUS 820 T23 R...*	23	11,5	141,22	142	20 • 30 35 40	0,60
KUS 820 T25 R...*	25	12,5	153,21	154,2	20 • 30 35 40 50 60	0,74
KUS 820 T27 R...*	27	13,5	165,21	166	20 • 30 35 40	0,88

* = Available upon request and minimum order quantity.
 • = Plain Bore. Without keyway. Tolerance $d1 = \begin{matrix} +0,3 \\ 0 \end{matrix}$
 Material: sprocket in polyamide (black).
 Bolts and nuts in stainless steel AISI 304.

Keyway: UNI 6604-69. See page 101.
 Max recommended tightening torque: 1 kgm.
 Half-section fixing nuts (self-locking).

KU 820

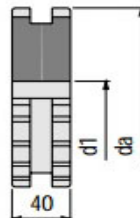

Thermoplastic (KU) Sprockets

Rexnord Order No.	No. of Teeth		Pitch Dia. d mm	Outside Dia. da mm	Plain Bore B mm	Max. Bore mm	Weight kg
	Actual	Effective					
KU 820 T19 R20*	19	9,5	117,35	117	20	60	0,40
KU 820 T21 R20	21	10,5	129,26	129	20	67	0,50
KU 820 T23 R20*	23	11,5	141,22	142	20	75	0,61
KU 820 T25 R20	25	12,5	153,21	154	20	80	0,74
KU 820 T27 R20*	27	13,5	165,21	166	20	85	0,88

* = Available upon request and minimum order quantity.
 Material: polyamide (black)

Plastkeðja beygja

Tegund

LF 880 K 325 TAB

LF 880 K 450 TAB

Allar tölur í mm

K	TT	G	H	R
82.5	4	11,5	16	457
114.3	4	11,5	16	500

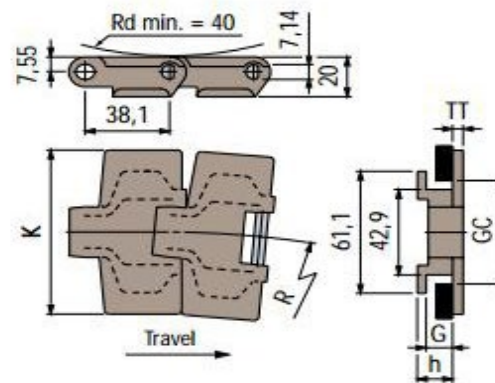

Plastkeðja beygja

Tegund

LF 880 K 325 BEV

LF 880 K 450 BEV

Allar tölur í mm

K	TT	G	R
82.5	4	16	457
114.3	4	16	457

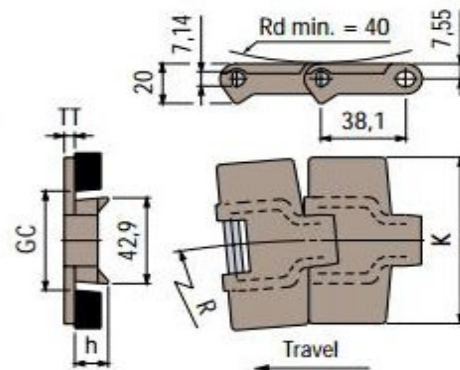

Plastkeðja beygja

Tegund

LF 882 K 750 TAB

LF 882 K 1000 TAB

K

194.5

254

R

610

610

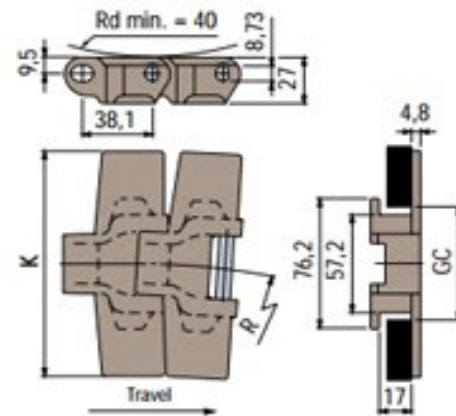

Tannhjólfyrir plastkeðju LF 880 og 882

KU 880

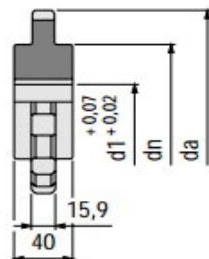

NS 880

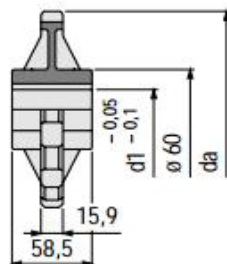

Thermoplastic (KU) Sprockets

Rexnord Order No.	No of Teeth	Pitch Dia. d mm	Outside Dia. da mm	Finished Bore with Keyway d1 mm	dn mm	Weight kg
KU 880 T10 R...*	10	123,29	122,5	20* 30 35 40	80	0,28
KU 880 T11 R...*	11	135,23	135	20* 30 35 40	85	0,35
KU 880 T12 R...*	12	147,21	147,4	20* 30 35 40	90	0,42

* = Available upon request and minimum order quantity.
 • = Plain Bore. Without keyway. Tolerance d1 = $\begin{matrix} +0,3 \\ 0 \end{matrix}$
 Material: polyamide (black).

Keyway: UNI 6604-69. See page 101.

Split Thermoplastic (NS) Sprockets

Rexnord Order No.	No of Teeth	Pitch Dia. d mm	Outside Dia. da mm	Finished Bore with Keyway d1	Weight kg
-------------------	-------------	-----------------	--------------------	------------------------------	-----------

Bore (mm)

NS 880 T10 R...*	10	10	123,29	122,5	25 30 35 40 45	0,30
NS 880 T12 R...*	12	12	147,21	147,4	25 30 35 40 45	0,37

Bore (inch)

NS 880 T12 R...*	12	12	147,21	147,4	1" 11/4"	0,37
------------------	----	----	--------	-------	----------	------

* = Available upon request and minimum order quantity.
 Material: sprocket in reinforced polyamide (black).
 Bolts in stainless steel AISI 304, nuts in nickel plated brass.

Keyway: UNI 6604-69. See page 101.
 Max recommended tightening torque: 1 kgm.

Hryggjarliðakeðja

Tegund
WLF 1703
Allar tölur í mm

R
140

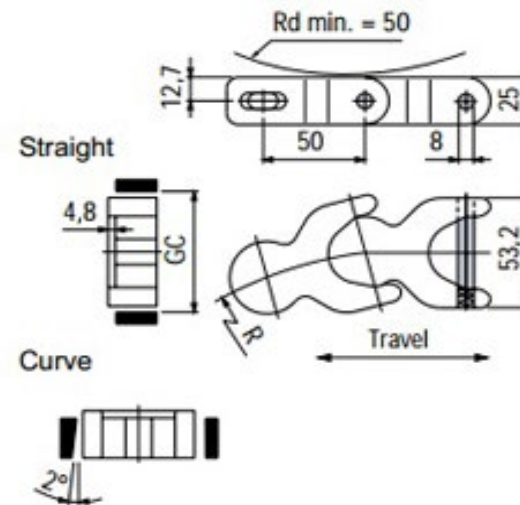

Tannhjól fyrir hryggjaliðakeðju

N 1700 AS

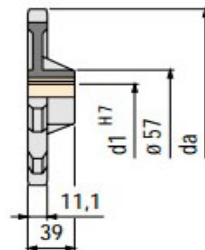

Thermoplastic (N) Sprockets

Rexnord Order No.	No of Teeth	Pitch Dia. d mm	Outside Dia. da mm	Finished Bore with Keyway d1 mm	Weight kg
N 1700 AS T10 R...*	10	161,8	165,1	24 25 30	0,40

* = Available upon request and minimum order quantity.
Material: polyamide (white). Brass hub.
Keyway: UNI 6604-69. See page 101.

Hliðarstýring með rúllum

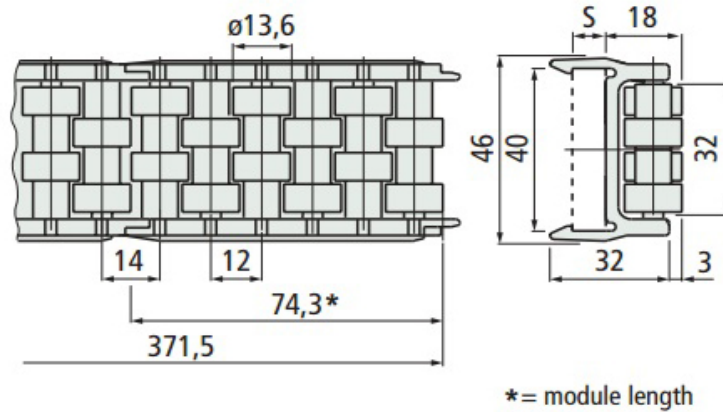

- Fixing with plate.

- ▣ 40 x 8
- ▣ 40 x 10

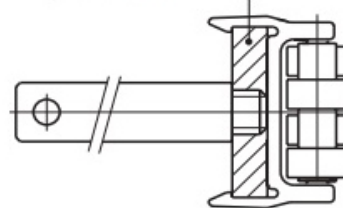

• Min. curvature radius Part. 580

- Fixing with metal profile Part. 537.

